

# Creative Images™ Color Slide:

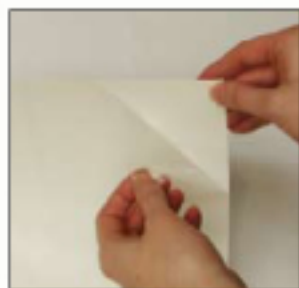

## A Users Guide

1. Prepare your original artwork. Images in digital format can be cropped, sized or otherwise altered to fit your desired specifications.
2. Remove the separator sheet from between pieces. Load paper into a color copier or color laser printer. (Paper is not compatible with home copiers using ink-jet printing.)  
*Note: It is important to print to the gloss side of the paper. Refer to loading instructions for the printer or copier to ensure paper is loaded correctly.*
3. Print or copy your image. Allow to stand briefly in the cooling tray of the copier or printer before handling.
4. Cut your image to size, leaving a narrow border of unprinted paper around the image.
5. Cut, clean and prepare the glass your image will be applied to.
6. Select a clean container wide enough to fit your printed image without folding. Fill with several inches of warm water.
7. Soak printed image in warm water approximately 30 seconds, or until the image slides easily off the paper backing.
8. Gently transfer the image to glass, being careful to avoid folding, bunching or stretching the image.
9. Lay glass flat, and using a damp sponge or cloth, wipe from the center of the image outward to push air bubbles out and smooth the image to the glass.
10. Allow to dry completely.
11. Preheat oven to 376° F.  
*Note: To ensure appropriate curing temperatures are achieved, an oven thermometer can be used to calibrate your temperature.*
12. Place glass on oven rack and bake for 15 minutes.
13. Turn off the oven and open the door partially. Allow to cool 20 minutes or until comfortable to handle.
14. Add your completed color image to your stained glass or mosaic art.  
*Note: For best results, mask off your color image with painters tape while applying flux, patina, or other harsh chemicals or abrasives.*



**DELPHI**  
*Be Creative!*

DelphiGlass.com • info@delphiglass.com  
To Order 800-248-2048  
Project Help Line 800-821-9450  
© Copyright 2009 Delphi Creativity Group.